

De haut en bas

1 Hêtre de Charente-Muritime
2 Meulière française
3 Plâtre parisien
4 Tuile provençale

5 Bois de chêne de l'Alsie
6 Esquisse du Nord-Pas-de-calais
7 Marbre sculpté
8 Bois de pin des Landes

9 Pierre de Souppes
10 PSE de terres d'Auvergne
11 Granit breton
12 Lin normand

European Heritage Days

Sustainable heritage

2022
17—18.09

Photographie
Dessin graphique
Renzo Stello

www.journeesdupatrimoine.fr
#JournéesDuPatrimoine



MORE INFORMATION ON
<https://www.senat.fr/evenement/patrimoine/2022.html>
Contact: jepsenat@senat.fr
Phone: +33 (0)1 42 34 45 45

PALAIS DU LUXEMBOURG
Place Paul Claudel
Porte Odéon du Jardin du Luxembourg
75006 PARIS



02 | A WORD FROM THE PRESIDENT OF THE SENATE

European Heritage Days (EHDs) are a resounding success each year, attracting millions of visitors and bearing witness to the public's interest in our monuments and institutions. I am therefore particularly pleased that the Senate will be opening its doors to visitors over these two days.

For the parliamentary assembly that I chair, this new edition of EHDs is a shared privilege, providing an opportunity to reach out to French people in order to show them the history of the Palais du Luxembourg and familiarise them with the workings of a modern, forward-looking parliament that is open to society.

You will enter the Senate Chamber where the 348 sitting Senators, elected for six-year terms, represent all the territories of the French Republic. They are responsible for passing the laws of the French Republic, which they also initiate, but also for monitoring the Government's actions and evaluating public policies, while also exercising specific responsibility in representing our compatriots living outside France.

This dual legacy – political and heritage-related – is a binding commitment. The preservation of this cradle of our history is a daily challenge, concerning some twenty buildings, the most important of which date from the 16th and 17th centuries, which must be equipped with the efficient technical facilities required to enable the performance of all the tasks carried out by a democratic parliamentary assembly under optimal conditions.

Our actions perfectly embody the theme of sustainable heritage, which is central to this 39th edition of European Heritage Days. These efforts promote the preservation of our heritage for the benefit of future generations, forging an essential link in response to the challenges, chiefly ecological and climatic, facing our societies.

In addition to these awareness-raising efforts, we have done our utmost to ensure that your visit will be both useful and enjoyable, combining learning for older visitors with entertainment for younger ones, and featuring sonic experiences that can be enjoyed again and again in our podcast audio library.

A world of wonders await you, from historical secrets to architectural gems, as you stroll from one room to another. I also recommend that you visit the Jardin du Luxembourg, one of Paris' most delightful gardens and voted Europe's most beautiful garden by Internet users this year, which the Senate maintains with particular emphasis on sustainable practices.

We look forward to welcoming you all.



GÉRARD LARCHER,
PRESIDENT OF THE SENATE

THE LUXEMBOURG PALACE



THE CONSTRUCTION OF THE LUXEMBOURG PALACE BEGAN IN 1615 AT THE BEHEST OF MARIE DE MEDICIS AND WAS COMPLETED AROUND 1630. MARIE DE MEDICIS TOOK UP RESIDENCE IN THE WEST WING OF THE PALACE AS OF 1625. SHE STAYED THERE UNTIL SHE HAD TO LEAVE FRANCE IN 1631, FORCED TO EXILE BY HER SON LOUIS XIII AFTER THE EVENTS KNOWN AS THE “DAY OF THE DUPES”.

The Palace remained a princely estate lived in successively by Louis XIII's brother, Gaston of Orleans (1642), then by his widow and his daughters among whom the Duchess of Montpensier known as the *Grande Mademoiselle* and the Duchess of Guise (1660), who offered it to Louis XIV in 1694.

In 1715, the Regent Philippe of Orleans inherited it before giving it up to his daughters, the Duchess of Berry and Louise Elisabeth of Orleans, former Queen of Spain. In 1778, Louis XVI gave the Palace to his brother the Count of Provence, who would later become King Louis XVIII. He fled the Revolution. The Luxembourg Palace became a prison before being assigned to the *Directoire* in 1795 and to the *Sénat Conservateur* (Conservative Senate) at the end of 1799. It then underwent profound architectural changes under the direction of Jean-François-Thérèse Chalgrin (1739-1811) to better suit its new parliamentary function.

In 1814, under the *Restauration*, the Luxembourg Palace was allocated to the *Chambre des Pairs* (Chamber of Peers). During the July Monarchy, the increasing number of Peers of France led architect Alphonse de Gisors (1796-1866) to push the Palace's South-facing wall 30 meters forward into the Garden to allow for the construction of the current *Salle des Séances* (Senate Chamber)

and Library. In 1852, he made the most of this enlargement by building the main gallery, then known as the *Salle du Trône* (Room of the Throne) and currently referred to as the *Salle des Conférences* (Conference Hall). The Palace was then allocated to the Senate of the Second Empire, after hosting the short-lived *Commission du gouvernement pour les travailleurs* (Workers governmental committee) of the Second Republic, in 1848.

Following the demise of the Second Empire, the Palace housed the Seine *Préfecture* and the meetings of the town council, after the Paris town hall had been set on fire during the Commune. In 1879, all seats of public offices were transferred from Versailles to Paris and the Luxembourg Palace was allocated to the Senate of the Third Republic until 1940, when it was then occupied by the *Luftwaffe* command staff for Western Europe.

In 1944, it became the seat of the provisional Consultative Assembly. The Higher Court of Justice held its meetings there in 1945 as well as the 1946 Peace Conference.

The Palace was allocated to the Council of the Republic at the end of 1946 before becoming home to the Senate of the Fifth Republic in 1958.

LUXEMBOURG PALACE
EUROPEAN HERITAGE DAYS 2022

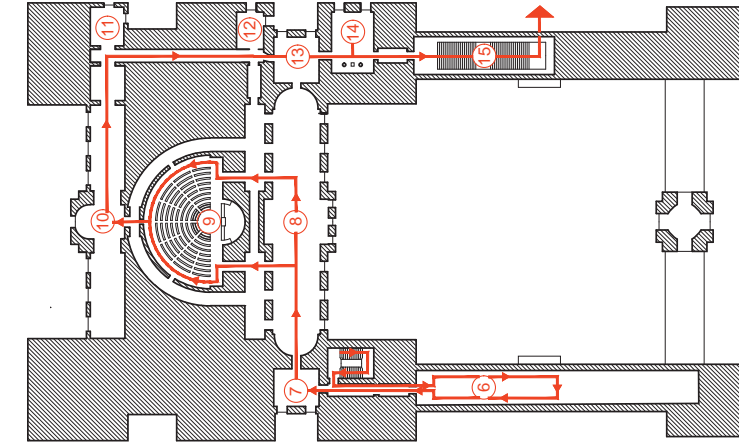

1ST FLOOR PLAN

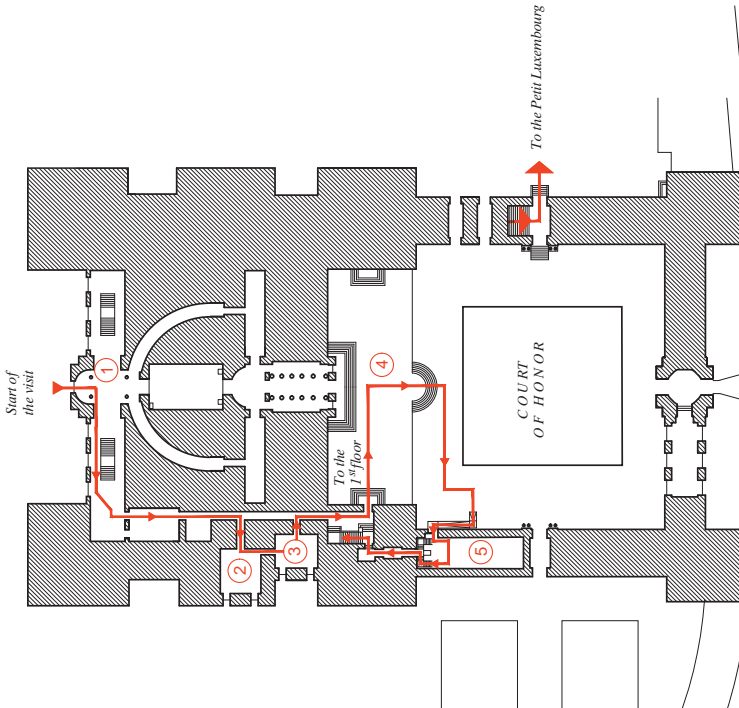

0 10 20m

Rue de Vaugrand

GROUND FLOOR PLAN

LUXEMBOURG PALACE

EUROPEAN HERITAGE DAYS 2022

ROUTE FOR PEOPLE WITH REDUCED MOBILITY

The room numbers correspond to the guidebook.

Rooms are visited in the following order:

- 1 - 3 - 2 - 6 - 7 - 8 - 9 - 10 - 11 - 12 - 13 - 14 - 15 - 4 - 5.

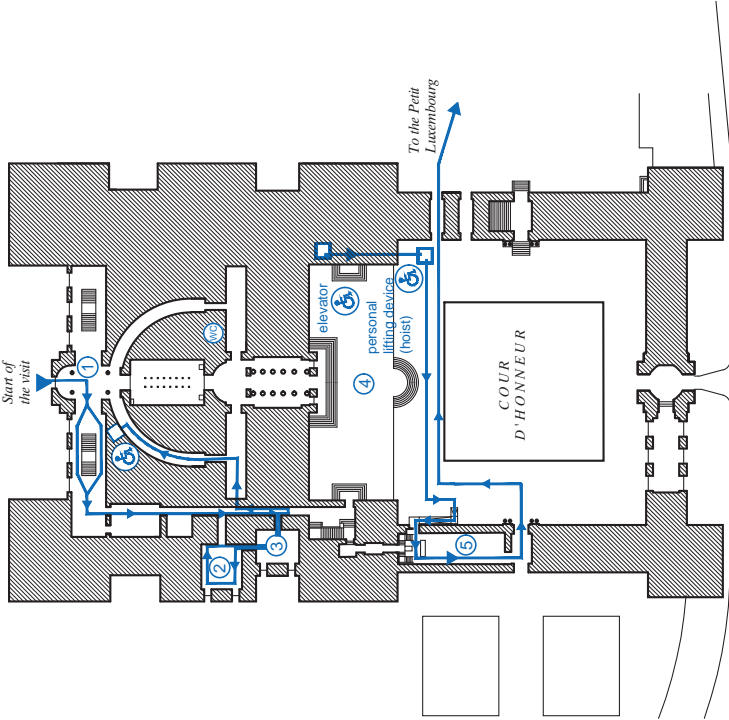

GROUND FLOOR PLAN

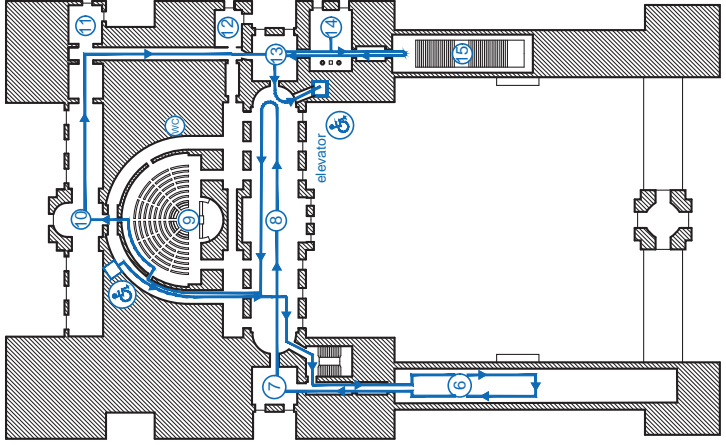

1ST FLOOR PLAN

06 | WELCOME TO THE SENATE

ROOM 1

GALLERY OF QUESTEURS

Designed by Alphonse de Gisors, it opens onto the garden, on the south side of the building.



ROOM 2

ROOM OF THE GOLDEN BOOK



Decorated in 1817 by architect Baraguey with painted wooden panels taken from the apartments of Queen Marie de Medicis at the Luxembourg Palace and wood panelling taken from the royal apartments of Queen Anne of Austria, at the Louvre.

ROOM 3

OFFICES OF A VICE-PRESIDENT OF THE SENATE

Former reading room of the Peers of France.

These offices are shown to the public for their patrimonial relevance. They are not, however, the current senators' offices, which are for the most part located on 26 and 36 rue de Vaugirard and are much more functional and smaller in size.

ROOM 4

MODULAR CONSTRUCTION AND THE COURT OF HONOUR

Before reaching the stairs, you will see a modular construction in the Court of Honour of the Luxembourg Palace. This building, set up in the spring of 2017, will be operational as of October 2017. Its 134 temporary offices spread on four floors will house some Senators and their assistants during the renovation works of the buildings located between 26 and 36 rue de Vaugirard.

ROOM 5



RENÉ MONORY HALL

A former chapel (1843-1870), this room still boasts several religious paintings made between 1844 and 1845 to adorn the Chapel of the French House of Peers. During the Third Republic, this chapel was used as a meeting room. From 2016 to 2018, the Senate carried out major renovations to restore its interior decoration and transform this room into a modern multimedia facility equipped with an audiovisual recording system to enable the broadcasting of its meetings by video on demand. The Bureau of the Senate has named this room after René Monory, as a tribute to the Vienne Senator and former President of the Senate (1992-1998). It was inaugurated by the current President of the Senate, Mr Gérard Larcher, on 17th January 2018.



ROOM 6



LIBRARY ANNEX

The Great Gallery, now referred to as the *Annexe de la Bibliothèque* (Library Annex), was completed in 1630. Stretching along the whole length of the east wing of the building, it was originally designed to display 24 paintings of Rubens (1577-1640) in honour of Henri IV, but that project never came to fruition. This is where the first European painting museum open to the public was set up from 1750 to 1780. During the French Revolution, that part of the Palace was turned into a *maison nationale de sûreté* (national safety house). Another museum for contemporary art was established there from 1803 to 1815 and from 1818 to 1886. In 1886, the Luxembourg Museum took up its new quarters, managed by the Senate, in the rue de Vaugirard, opposite rue Férou. The former gallery became the Library Annex in 1887. Prison cells were fitted there during the trials of Paul Déroulède and other members of the League of Patriots, judged in 1899 by the Senate turned High Court of Justice.

The vaulted ceiling, massively restored in 2010, features a series of paintings by Jacob



Jordaens (1593-1678) representing the Twelve Signs of the Zodiac. This room also contains a bronze bust by American sculptor Jo Davidson (1883-1952) of Literature Nobel Prize winner Anatole France, who worked in the Library for a time.



ROOM 7

VICTOR HUGO LOUNGE

This room owes its name to the bust sculpted by Antonin Mercié in 1889 of illustrious writer and Parliamentarian Victor Hugo, who was a Peer of France from 1845 to 1848 and a senator during the Third Republic from 1876 until his death on 22nd May 1885.



ROOM 8



CONFERENCE HALL

57 meters long, 10.60 meters wide and 11 meters high (15 meters under the dome), this room designed by Alphonse de Gisors, completed in 1854, was created by assembling three separate rooms from the original building. Its decoration is a very fine example of Second Empire style. At each end of the room, on the ceiling's covings, one can admire depictions of the History of France from its origins until Charlemagne (at the west end) as well as a fresco by Henri Lehmann (1814-1882) of the period running from the first Crusade to Louis XIV (at the east end). The ceiling features *L'Âge de la Paix* (The Age of Peace) and *L'Âge de la Victoire* (The Age of Victory) by Adolphe Brune. Eight tapestries from the Gobelins illustrating Ovid's *Metamorphoses* complete the decor.



EXHIBITION OF BUSTS OF "MARIANNE"

A symbol of the French Republic, "Marianne" was portrayed in various ways since the Convention decided, in 1792, to associate the New Régime to the image of a woman wearing the Phrygian cap (liberty cap).



GALLERY OF BUSTS

Built over the original terrace overlooking garden, this long corridor is named after the busts of statesmen it is lined with.

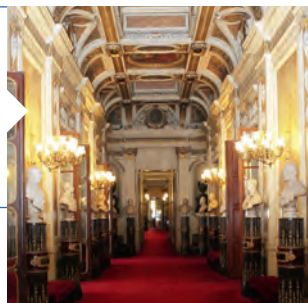

ROOM 9



SENATE CHAMBER

Made up of two facing semicircles, it was built from 1836 to 1841 following the plans of Alphonse de Gisors. The smaller semicircle's semi-dome is supported by eight stucco columns separated by seven statues of prestigious legislators. The paintings on the left and right sides of the smaller semicircle's vault, by Merry-Joseph Blondel (1781-1853), depict the crowning of Philippe le Long and Louis XII at the *États de Tours* in 1506. The alcoves contain statues of Charlemagne by Antoine Etex (1808-1888) and of Saint-Louis by Augustin Dumont (1801-1884).



The busts of four Marshals of the Empire (Masséna, Lannes, Mortier and Gouvion-Saint-Cyr) are located between the benches.

The vaulted ceiling in front of the benches is painted with allegories of Prudence (Caution), Truth and Protection by Théophile Vauchelet dating back to the middle of the 19th century. The room also features beautiful sculpted oak panelling by J.B. Klagmann, J.-J. Elshoëcht and H. de Triqueti. There are 348 seats, allocated in proportion to the number of members in every political group. Each senator has her or his own designated seat according to their party.

Fifteen desks display commemorative medallions of former senators Victor Hugo, Victor Schoelcher, Pierre Waldeck-Rousseau, Marcellin Berthelot, Émile Combes, Georges Clemenceau, Raymond Poincaré, René Coty, Gaston Monnerville, François Mitterrand, Michel Debré, Alain Poher, Edgar Faure, Maurice Schumann and Gaston Doumergue.



→ **Did you know?** In the night of 27th to 28th October 1859, shortly after 1 am, a fire with unknown causes destroyed the roofing of the *Palais du Luxembourg* (Luxembourg Palace). This fire led to the creation of a fire station attached to the *Palais du Luxembourg* and the implementation of the night rounds.

10 | WELCOME TO THE SENATE



Details of the dome



ROOM 10



LIBRARY

Completed by Alphonse de Gisors, with ceilings by Louis Antoine Riesener (1808-1878) and Camille Roqueplan (1802-1855). The dome features a painting by Delacroix (from 1841 to 1846) of the Limbo, described by Dante in *The Divine Comedy*, in Canto IV of the *Inferno*, representing the Great Men of ancient times. Still in the dome, four hexagonal medallions by the same artist evoke Theology (St Jerome), Philosophy (Aristotle's Muse), Poetry (Orpheus) and Eloquence (Cicero). Between the dome and the window, on the ceiling's coving, Delacroix painted Alexander after the Battle of Arbeles, asking for Homer's poems to be deposited in Darius' golden chest. One can notice this piece of furniture, specially designed by cabinetmaker Charles Morel to provide a copy of the "*Description of Egypt*" carried out during Napoléon Bonaparte's expedition.



ROOM 11

QUESTEUR'S OFFICE

This room, decorated by Alphonse de Gisors at the same period as the Library, used to be a study. It is now used for the weekly meetings of the Conseil de Questure, which comprises of three Questeurs elected by their colleagues to manage the Senate's administrative matters and run its budget.

ROOM 12

DEPARTURE CABINET

The former *cabinet doré* (gilded cabinet) or *mariages Medicis* (Cabinet of Medicis weddings), this is now the room the chairman of parliamentary sessions departs from in order to go to the *Salle des Séances* (Senate Chamber).

ROOM 13

MESSENGERS OF STATE LOUNGE

A former antechamber at the time of Marie de Medicis, this room was turned by Chalgrin into a lounge for the Empire's Messengers of State (who acted as intermediaries between the authorities, carrying bills and official documents).



ROOM 14

QUEEN'S BEDROOM

This was Marie de Medicis's ceremonial bedroom and may have been the room where the first act of the *Journée des Dupes* (Day of the Dupes) unfolded.

THE "DAY OF THE DUPES"

This is the room where one of the most crucial days of French history, the "Day of the Dupes", may well have taken place. On 10th or 11th November 1630, two influential characters confronted each other under the arbitration of the young King Louis XIII: on the one hand, his mother the Queen, Regent until 1615, who wished to maintain peaceful relations with catholic powers; on the other hand, the Cardinal Richelieu who encouraged the King to support France's protestant adversaries regardless of family ties by waging a war against his father-in-law the King of Spain and his brother-in-law the Duke of Savoie.

Marie de Medicis summoned the King, asking him to dismiss Richelieu. However, the latter, informed by his agents, wormed his way into the Palace through a hidden door and managed to enter the room. The Queen reacted vividly but the Cardinal threw himself at her feet, assuring her of his loyalty. Louis XIII asked the Cardinal to leave and wait for his orders.

Marie had openly triumphed. Convinced he had lost, the Cardinal burnt his documents and had his most precious belongings sent over to The Havre. Meanwhile, Louis XIII went back to Versailles where he called in Richelieu and declared: "Sir, you have my entire trust. I am more obliged to my State than to my mother."

The Queen's partisans only realized what had just happened on the following day. They were moved away from power. Some of them, such as Louis de Marillac, were even executed. As to the Queen Marie, she was forced to exile.

PIÈCE 15



ESCALIER D'HONNEUR

It was built by Chalgrin (between 1800 and 1803) at the expense of the gallery of Rubens whose 24 paintings on the life of Marie de Medicis are now exhibited at the Louvre. The vaulted ceiling is ornamented with roses and coffers. Above the doors, various Victories are represented on stone bas-reliefs, while the side walls are decorated with ten verdure tapestries.

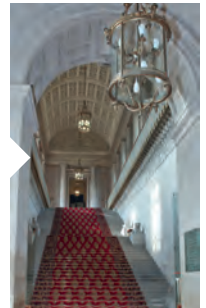

THE PETIT LUXEMBOURG

(RESIDENCE OF THE PRESIDENT OF THE SENATE)



Built toward the middle of the 16th century, this mansion was purchased in 1570 by François de Luxembourg, Duke of Piney and Peer of France, before it was sold in 1612 to Queen Marie de Medicis, who had her Palace built nearby. Both buildings were named after the Duke François de Luxembourg. Since then, the former mansion has been called the *Petit Luxembourg* to avoid any confusion with the larger Palace. It was given in 1627 to the Cardinal de Richelieu, who bequeathed it to his niece in 1639.

After it was inherited by the Condé family in 1674, the *Petit Luxembourg* was enlarged and redecorated by Germain Boffrand between 1709 and 1713. Louis XVI's brother, the Count of Provence, who would later become King Louis XVIII, set up house there for a time. During the Directoire, it was occupied by four Directeurs among whom Sieyès, who hosted the group who planned the coup of the 9th November 1799 (known as "18th Brumaire Year 8" in the French Revolutionary Calendar).

Napoleon Bonaparte settled down there with his wife Josephine after the coup and this is where the Constitution of the Year VIII was drafted. The Conservative Senate subsequently held its meetings there from 1800 to 1804 before moving into the Luxembourg Palace. In 1825, the *Petit Luxembourg* was given to King Charles X and used to accommodate the President of the Chamber of Peers, a lower house of Parliament, set up in 1814. It has kept its parliamentary function up to this day, except for three historical periods: in 1848, when it served as the residence of the Vice-President of the Republic and accommodated the *Tribunal des Conflits* (Court of Conflicts); from 1871 to 1879, when it was lived in by the prefect of the Seine after the fire of the *Hôtel de Ville* (town hall); and from 1940 to 1944, when it was occupied by the *Luftwaffe* command staff for Western Europe. After the War, the *Petit Luxembourg* went back to being the residence of the President of the upper house, of the Council of the Republic from 1946 to 1958 and of the Senate under the Fifth Republic from 1958 onward.



**PETIT LUXEMBOURG
(RESIDENCE OF THE PRESIDENT OF THE SENATE)**
EUROPEAN HERITAGE DAYS 2022

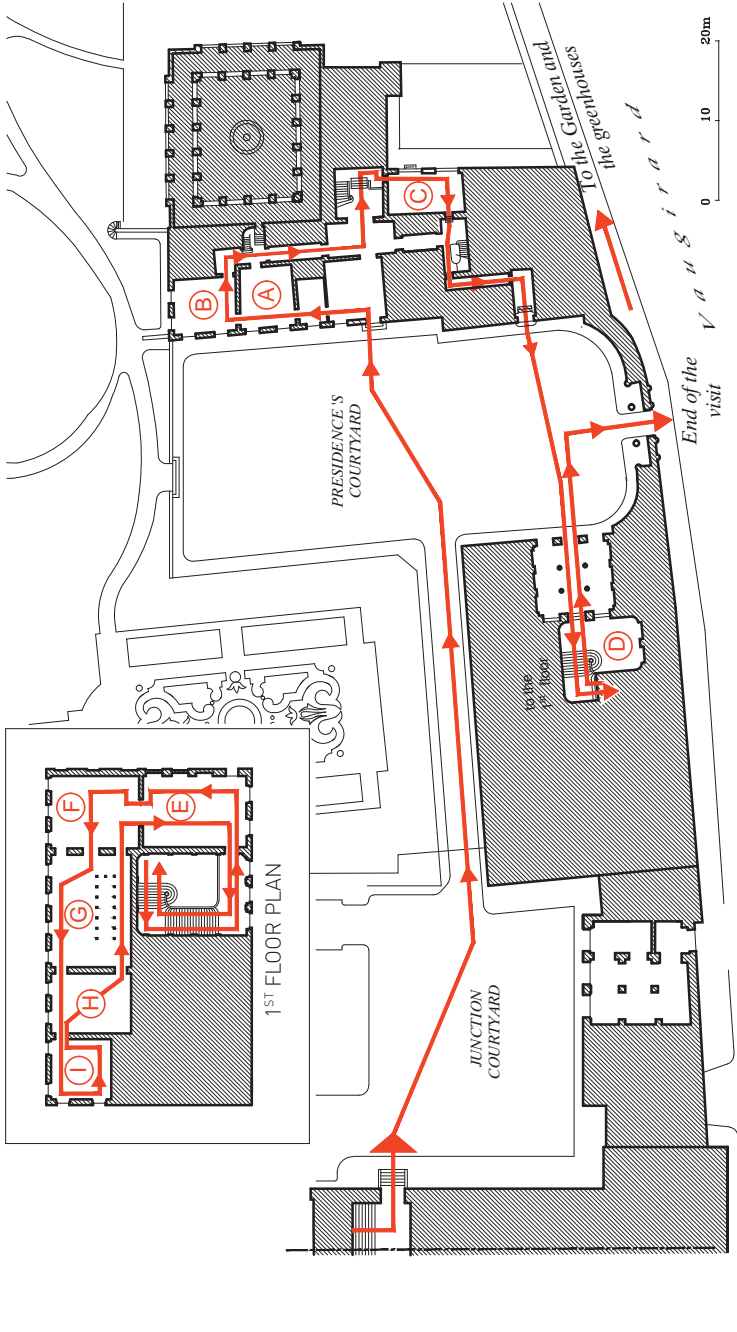

GROUND FLOOR PLAN

**PETIT LUXEMBOURG
(RESIDENCE OF THE PRESIDENT OF THE SENATE)**
EUROPEAN HERITAGE DAYS 2022

— ROUTE FOR PEOPLE WITH REDUCED MOBILITY —

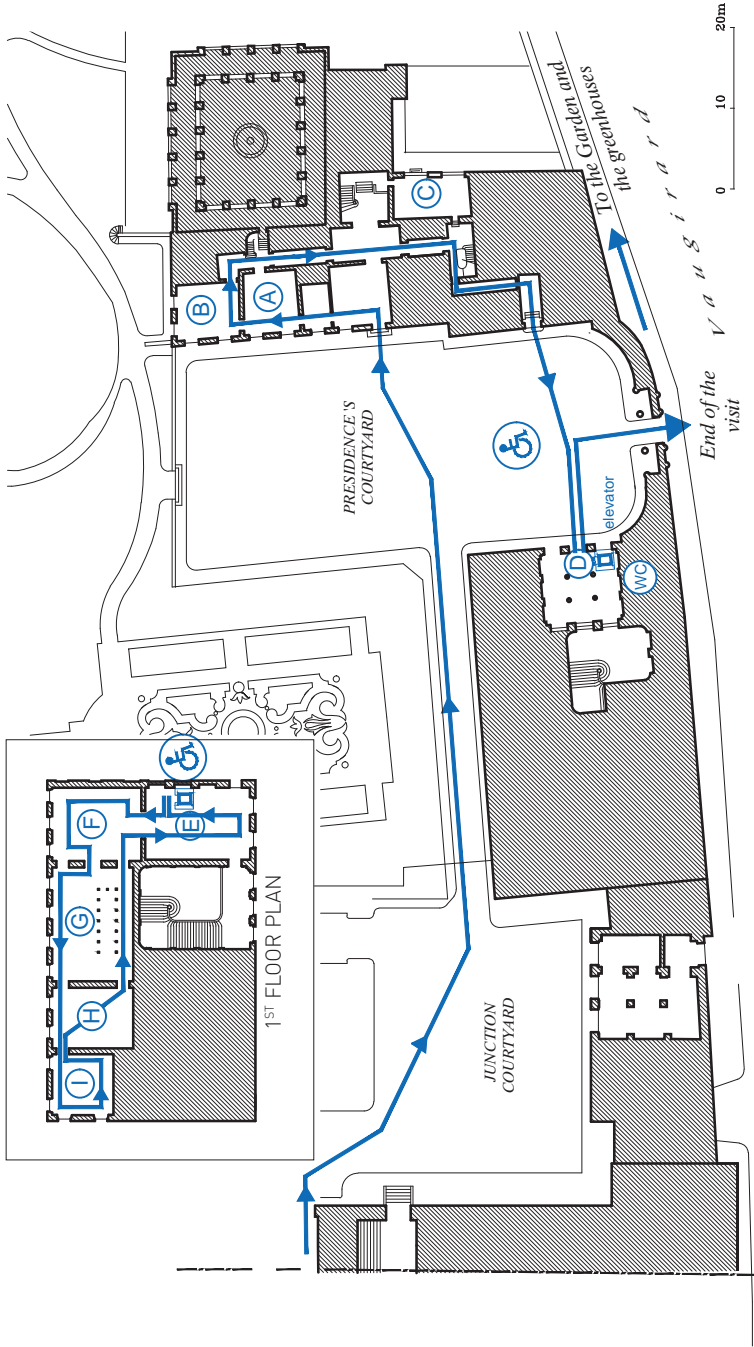

LEFT WING (WEST)

BUILT AND DESIGNED BY BOFFRAND IN PLACE OF 16TH CENTURY OUTBUILDINGS, IT NOW HOUSES THE PRESIDENT'S OFFICES.

ROOM A

OFFICE OF THE DIRECTOR OF THE CABINET

This room contains three paintings, among which "A Water Fountain in the Tuileries" ("Jet d'eau aux Tuileries") by Gaston de La Touche, kept at the Musée d'Orsay.



PIÈCE B

OFFICE OF MR GÉRARD LARCHER, PRESIDENT OF THE SENATE

This is probably where Napoleon Bonaparte, then First Consul, had his study between 10th November 1799 and 19th February 1800. The decor dates back from the beginning of the 19th century.

- "Empire" style furniture.
- Paintings: *Un prédicateur dans les ruines* (A preacher in the ruins) (1743) by Giovanni Paolo Pannini (1691-1765), on deposit from the Louvre Museum. *Le Champignon* (The Mushroom) nickname formerly given to the Luxembourg Garden's guardroom (1902) by Albert Marquet (1875-1947).

ROOM C

QUEEN'S CHAPEL

In 1625, Marie de Medicis set up the congregation of the "Daughters of the Calvary" next to the Luxembourg Palace. Some of these buildings were destroyed in 1844.

From 1845 to 1854, architect Alphonse de Gisors recreated a baroque style chapel in one of the aisles of the former church.



RIGHT WING (EAST)

THIS MANSION, PREVIOUSLY OWNED BY DUKE FRANÇOIS DE LUXEMBOURG. WAS REFURBISHED BY BOFFRAND (1667-1754). NOWADAYS, IT IS USED FOR OFFICIAL RECEPTIONS.

ROOM D

STAIRWAY BY BOFFRAND

A monumental stairway with a stone balustrade, the pattern of which is echoed in the mirror-covered archways above.



ROOM E

USHERS' LOUNGE

A 20th century set by Jacques Despierre on the theme of "seasons in the garden" (spring, summer and autumn).

ROOM F

TAPESTRIES' LOUNGE

The name of this room stems from the various tapestries that used to hang on its walls, including a tapestry of the Triomphes des Dieux ("Triumphs of the Gods") of which one copy remains. Three paintings by Jean-François Hue (1751-1823) depicting the port of Lorient, and the port and naval harbour of Brest, on deposit from the Louvre Museum.

ROOM G

GRAND SALON

Decor by Boffrand restored in the 19th century. The lower part of the vaulted ceiling is surrounded by a cornice ornamented with a frieze of arabesques. Above the doors, representations of the Four Seasons painted by Louis de Boullogne (1654-1733). 19th century furniture and chandeliers.

ROOM H

PURPLE LOUNGE

Former bedroom of the Bourbon-Condé and of the Countess of Provence. Two portraits on deposit from Versailles, depicting Marshal Catinat, standing outdoors, by the painter Pierre-Jules Jolivet, and Count Dejean by Henry Serrur.

ROOM I

NAPOLEON LOUNGE

Decor by Boffrand revived under the Second Empire. Portrait of Napoleon wearing his coronation costume. Against the wall, a letter written by Napoleon to the senators is reproduced on a marble table.



THE SENATE



The Senate and the National Assembly form **the Parliament**.

Senators examine **government bills** submitted to them by the government. They may also submit and examine **parliamentary bills**.

They also **control the actions of the government** and make sure that the laws that were voted are indeed **enforced**.

The Senate ensures the representation of the territorial communities of the Republic.

The Senate ensures the institutions' **continuity**, since only **half** of the Senators are renewed every three years. Furthermore, unlike the National Assembly, **it cannot be dissolved**. Finally, the President of the Senate may be called upon to **replace** the President of the Republic when required.



EUROPEAN HERITAGE DAYS AT THE SENATE



Facebook
facebook.com/senat_fr



Twitter
twitter.com/Senat



Twitter Jardin
twitter.com/JardinLuco



Instagram
instagram.com/Senat_fr



LinkedIn
linkedin.com/company/senat



YouTube
youtube.com/senat

Share your most beautiful memories of the European Heritage Days at the Senate using the hash-word **#JEPSénat**

TOUR OF THE LUXEMBOURG GARDEN GREENHOUSES



The Luxembourg Garden is managed and maintained by the Senate. Since its creation by Marie de Medicis in the 17th century, it has featured collections of orangery plants and ancient fruit varieties accessible to the public all year round.

The greenhouses of the Luxembourg Garden have always enjoyed a worldwide reputation and been recognized for their know-how by the horticultural world. They contain collections of tropical plants, the most famous of which is the orchid collection dating back from the middle of the 19th century and composed of more than 13,000 specimens. The nearby *in vitro* growing and multiplication laboratory ensures their continuity.

Within this orchid collection, the collection of *Paphiopedilums*, also called "Venus' slippers" or "fairy slippers", contains three quarters of listed species, all from South-East Asia, as well as 450 horticultural hybrids and is recognized as a National Collection by the Conservatory of Specialized Vegetal Collections (CCVS).

Due to the layout of the premises, access to the Senate's greenhouses is closed to the public, except on the European Heritage Days.

The Gardening Division is responsible for the Luxembourg School of Horticulture, which has been providing free public classes since 1809.

RESTORATION OF THE MEDICI FOUNTAIN AND PONDS



The Senate is firmly committed to the conservation of its heritage, and commissioned the restoration of the famous Medici Fountain in the Jardin du Luxembourg in 2020 and 2021. After two years of major renovations, this landmark, which became a listed historical monument in 1889, and its two ponds, have been restored to their full splendour.



→ Guided tour of the garden:

www.senat.fr/visite/jardin/infos_pratiques.html

→ School of horticulture:

www.senat.fr/visite/jardin/index.html

→ Central Apiculture Society:

<https://www.la-sca.net/>



The greenhouses will open exceptionally on Saturday 17th and Sunday 18th September 2022 from 10 am to 6 pm last entry of the day.



MANAGED BY
THE SENATE



LUXEMBOURG GARDEN TOUR OF GREENHOUSES

EUROPEAN HERITAGE DAYS 2021

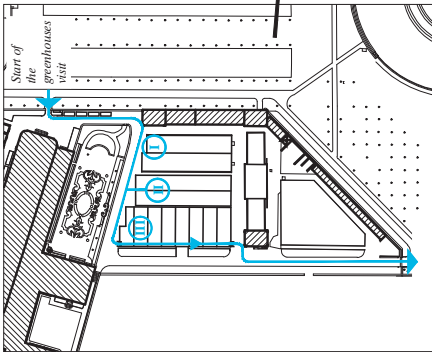

End of the visit

GREENHOUSES PLAN

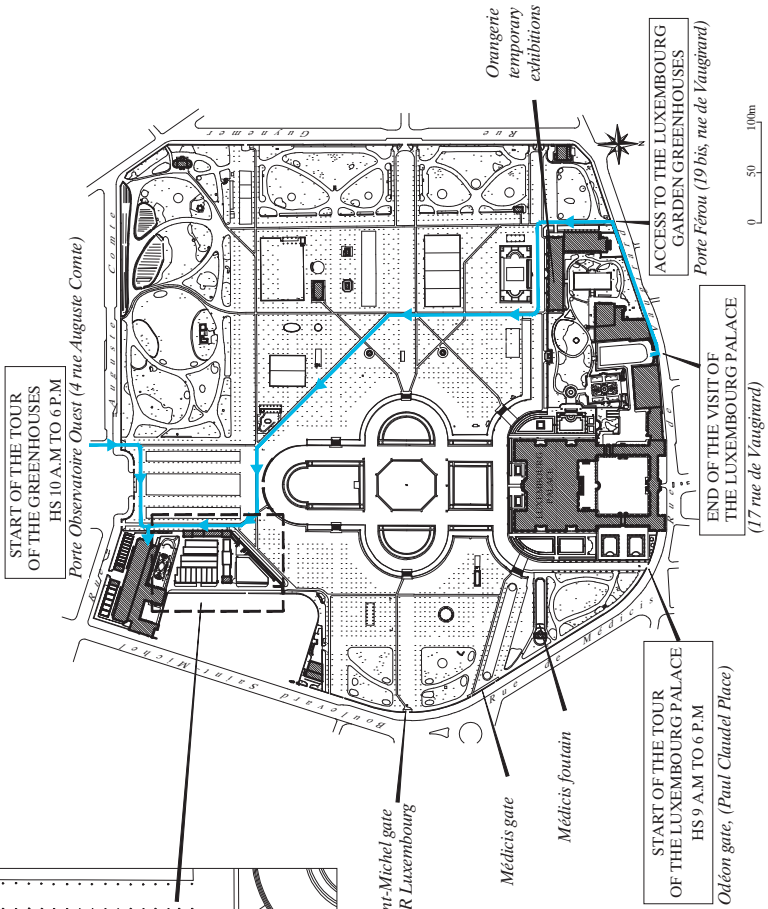

START OF THE TOUR
OF THE GREENHOUSES
HS 10 A.M TO 6 P.M

Porte Observatoire Ouest (4 rue Auguste Comte)

Saint-Michel gate
RER Luxembourg

Médicis gate

Médicis fountain

Orangerie
temporary
exhibitions

START OF THE TOUR
OF THE LUXEMBOURG PALACE
HS 9 A.M TO 6 P.M

Odeon gate, (Paul Claudel Place)

ACCESS TO THE LUXEMBOURG
GARDEN GREENHOUSES

Porte Férou (19 bis rue de Vaiguard)

END OF THE VISIT OF
THE LUXEMBOURG PALACE
(17 rue de Vaiguard)

0 50 100m

LUXEMBOURG GARDEN

→ Visiting the Palais du Luxembourg and attending parliamentary debates at the Senate

<http://www.senat.fr/visite/index.html>



→ Subscribe to the Senate newsletter

https://www.senat.fr/lettre/senat_hebdo.html



→ Staff at the Senate is recruited by competitive examination amongst civil servants with highly diversified profiles

<http://www.senat.fr/emploi/>



«Murmurs from the Palace»: a fascinating podcast journey

Scan the QR code posted in the rooms of the Palais du Luxembourg to discover a series of podcasts that will immerse you in the history of the Senate. Just scan the QR code and enjoy the journey!



SÉNAT

15 rue de Vaugirard

75291 Paris Cedex 06

Standard : +33 (0)1 42 34 20 00

<http://www.senat.fr>

